

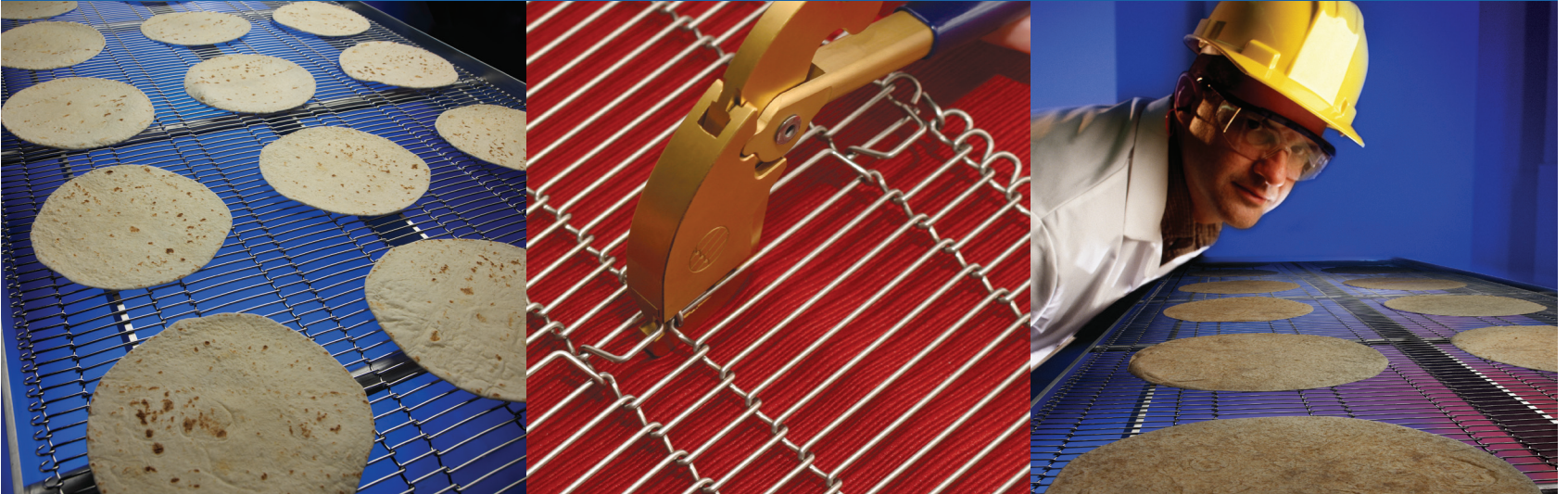

The Trusted Metal Conveyor Belt Manufacturer



— SUPERIOR TORTILLA COOLING — **TC-327™ CONVEYOR BELT** **WITH A TWO YEAR GUARANTEE!**

Introducing the TC-327™ tortilla cooling conveyor belt package from Wire Belt Company. Want longer belt life? You've got it! The TC-327™ tortilla cooling conveyor belt package is guaranteed to last two years on your conveyor circuit when properly installed and maintained. The TC-327™ tortilla cooling conveyor belt package comes with everything you need to setup your conveyor and get the most from your investment. Eliminate the many risks associated with plastic conveyor belts and make the safer, better, guaranteed choice with TC-327™.

TC-327™ ADVANTAGES:

- **Two Year Belt Life Guarantee!***
- 71% open surface area for maximum cooling!
- Clean-In-Place stainless steel belt design.
- Designed to provide optimum support for tortillas.
- Doesn't stretch or sag like plastic belts.
- No danger of catching fire like plastic belts can.

THE TC-327 PACKAGE COMES WITH EVERYTHING YOU NEED:

- TC-327™ conveyor belt.
- C-CureEdge® edge loops maximizes safety.
- Wire Belt drive components for your setup.
- Two EZSplice® joining strands.
- EZ-Splice® joining system tool kit.

*Speak with a Wire Belt Representative for details.

Wire Belt Company of America
154 Harvey Road, Londonderry, NH 03053
Tel: (603) 644-2500 | Fax: (603) 644-3600
Email: sales@wirebelt.com

www.wirebelt.com

SUPERIOR TORTILLA COOLING

TC-327™ CONVEYOR BELT

WITH A TWO YEAR GUARANTEE!

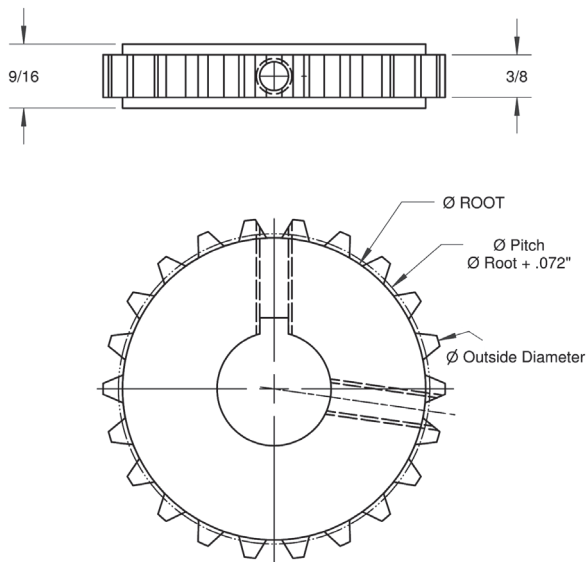
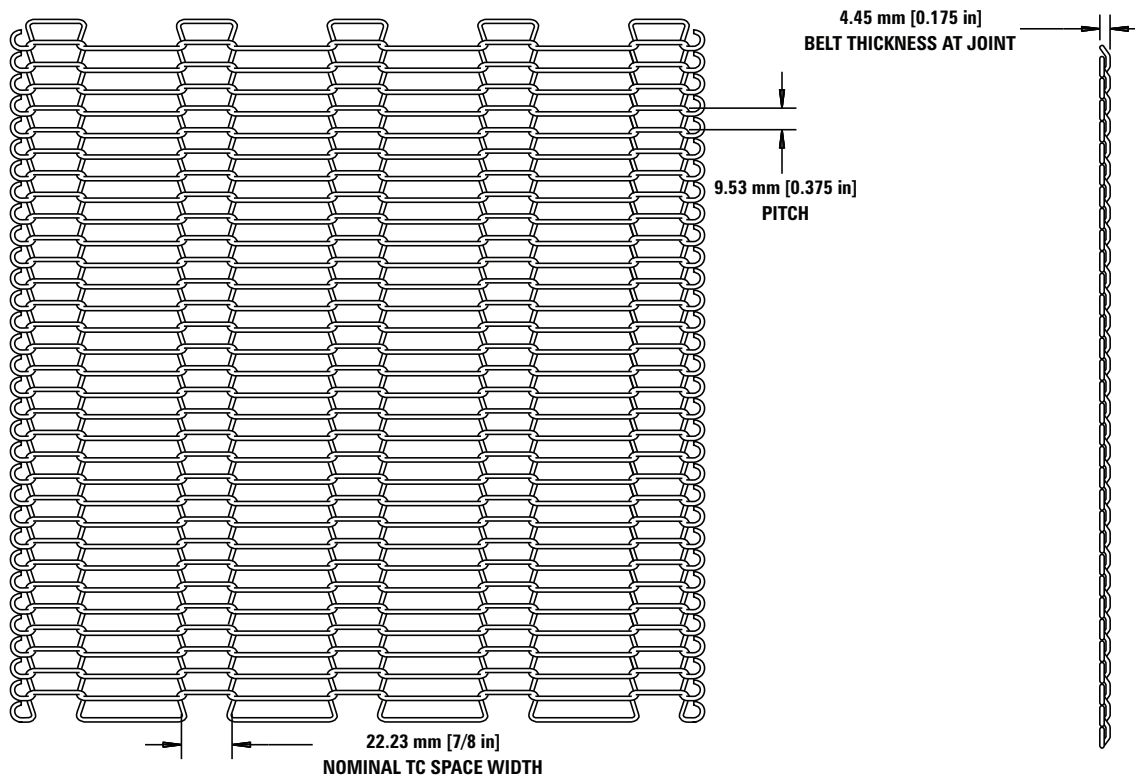

Product Summary	
Wire Diameter (inches)	.072
Strands/Foot	32(+0/-5)
Pitch in Inches (Max/Min)	.381/.375
Opening between Wires (Max/Min)	.309/.303
Belt Thickness at Joint (inches, +/- .005)	.205
End Loop Size (inches, +/- .0156)	.313
Min. Space Width (inches)	2.25
XT Space Width	.875
Weight per Sq. Foot (Average in lbs.)	.650
Max. Belt Load per Sq. Ft. (lbs.)	15
Max. Tension per Joint (lbs.)	18
Min. Sprocket Size (inches)	1.625
Min. Transfer Diameter (inches)*	.563
Max. Recommended Speed (FPM)	75
Typical Open Area (%)	71
*(non-grooved)	

Wire Belt Company of America
154 Harvey Road, Londonderry, NH 03053
Tel: (603) 644-2500 | Fax: (603) 644-3600
Email: sales@wirebelt.com

www.wirebelt.com